

Service instruction

Tail lift Change of oil

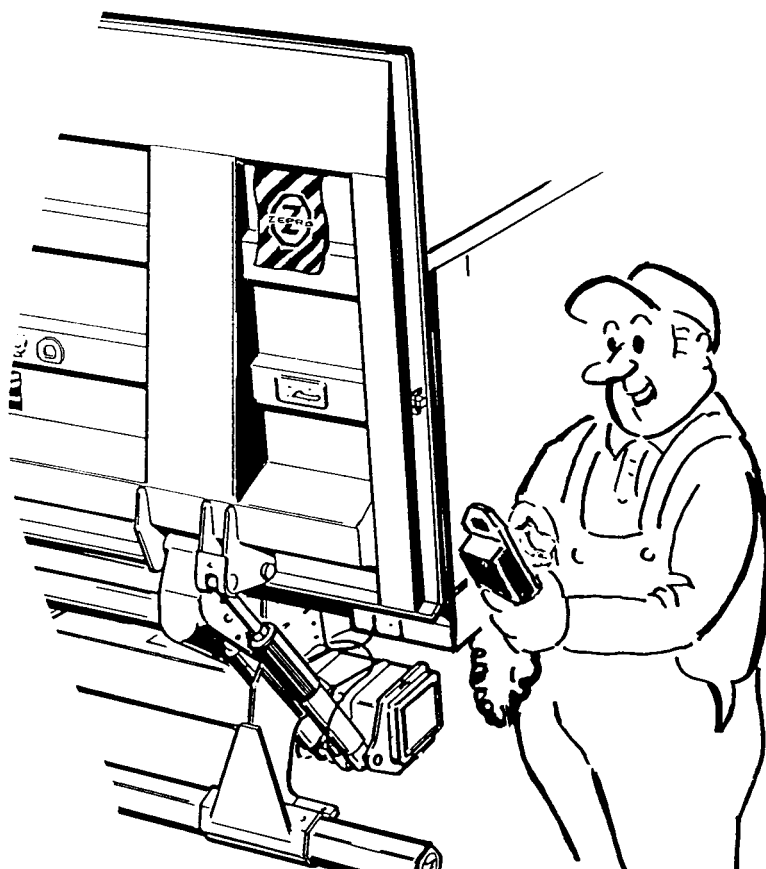

Contents

Change of oil

| | |
|---|--------------|
| <u>General Information</u> | <u>1</u> |
| <u>Z/ZL 150/200/250</u> | |
| <u>Z/ZL/ZN/ZHD/ZHDL/ZHDN 1500/2000/2500/3000</u> | |
| <u>ZHD/ZDK 250</u> | |
| <u>SZL/SZN 1500/2000</u> | <u>2-4</u> |
| <u>Cleaning tank, replace strainer for above models</u> | <u>5-6</u> |
| <u>Z/ZL/ZN/ZU/ZLU/ZNU 45/75 och Z 100</u> | <u>7</u> |
| <u>Z 10/15/20-130/150</u> | <u>8</u> |
| <u>Z 10-135</u> | <u>9</u> |
| <u>ZAHD/ZAEDH 150/200</u> | <u>10-13</u> |
| <u>ZD/ZS/ZT 15/20/25</u> | <u>14</u> |
| <u>ZHZ 600</u> | <u>15</u> |
| <u>ZKZ 1500</u> | <u>16-18</u> |
| <u>Z3N/Z3NU 75</u> | <u>19</u> |
| <u>SZFT/SZFTN/SZFTS 200-160</u> | <u>20</u> |
| <u>ZR 10/15 - 135</u> | <u>21</u> |
| <u>ZR 15/20 - 140/157</u> | <u>22</u> |
| <u>BZ/RZ 20-150</u> | <u>23</u> |
| <u>BZ/RZ 15/20-154</u> | <u>24</u> |
| <u>BZ/RZ 10/15/20-130/149</u> | <u>25</u> |
| <u>Replace oil filter</u> | <u>26-27</u> |

General Information

Change of oil

Please read all instructions before you start.

Hydraulic cleanliness / Hydraulic oil

At all handling of hydraulic components high cleanliness must be held.

- * At demounting of hydraulic system, the working areas must be well cleaned from dirt in all shapes.
- * All components must be well cleaned before demounting.
- * Unless hydraulic system should be mounted right away after demounting, the details must be kept in such a way that they don't expose to unnecessary contamination.
- * At oil change, be sure that filler tank are well cleaned outside and well cleaned strainer is used while filling up.
- * Filler cap must be dried of before removing.
- * Rags and papers made of non fluffing materials must be used when working areas and tools are cleaned.
- * Paste-up grease must be avoided. If there are needs for lubrication, use hydraulic oil.
- * At oil change, Zepro original oil or similar must be used:

Arctic conditions
ISO VG 22 or VG 32, ISO 11158 HV
and DIN 51524 HVLP.

Castrol Hyspin AWW 32
BP Energol HFV-LT
Shell Tellus Arctic
Texaco Rando Ashless 8401
Esso Unavis HVI 26
Statoil 131
OK/Q8 Hindemith LT
Mobil Aero HF or HFA*
Neste Hydraul Super 28

Tropical conditions
ISO VG 46 or VG 68, ISO 11158 HM
or HV and DIN 51524HLP or HVLP.

Castrol Hyspin AWH 46 or 68
BP Bartran SHF-S 46 or HV 68
Shell Tellus TX 46 or 68
Texaco Rando HDZ LT46 or HDZ68
Esso Unavis N 46 or 68

OK/Q8 Handel 46 or 68
Mobil DTE 10M-serien, 15M or 16M
Neste Hydraul 46 or 68

*Not a HF oil, as described below.

* NOTE! ATF and HF oils are not allowed to use.

HF oils contain additives and these can have negative effect on polyurethane, that most of our cylinder sealing are made of. Also ATF oils contain additives that affect plastic and rubber materials negatively. The result may be cylinder leakage.

ATF = Automatic Transmission Fluid
HF = High flash point

Change of oil at Z/ZL/ZN/ZHD/ZHDL/ZHDN 1500/2000/2500/3000 Z/ZL150/200/250 ZDK/ZHD 250 SZL/SZN 1500/2000 models

Preparation

- See to have a tray or a can for waste oil at hand.
- Ensure yourself that lift is entirely raised up and closed against body.

During these operations, no staying behind the platform.

- Start by pulling the hydraulic unit out from the support frame. Loosen the cable on the solenoid that goes to the motor. Se fig. Thereafter suck the tank empty from oil.

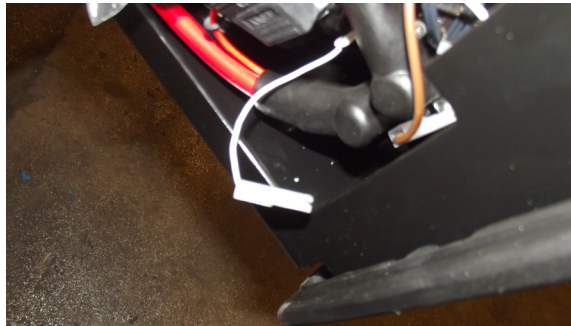

- Loosen the hose connected to P1 and put in a spill tray, make sure the hose connection is not present below the surface of oil. Plug connection to P1 on the valve system or connect an independent hose and place the other end in the spill tray..

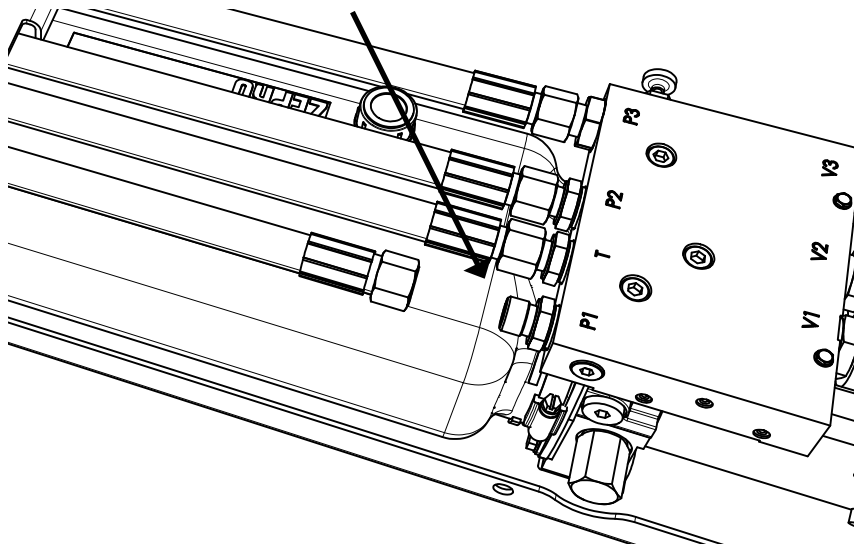

Emptying the tilt cylinders

- Use the control unit to tilt down the platform as much as possible, so that the tilt cylinders will be empty from oil as much as possible. If the platform does not move, try with a crowbar or a breaking bar help the platform to start tilting down. This may be necessary because the motor is switched off and the platform is lowered by its own weight.
- Once again, suck the tank empty from oil.

Emptying the lift cylinders

- Loosen the hose connected to T and place in a spill tray, make sure the hose connection is not present below the surface of oil. Plug connection T on the valve system or connect an independent hose and place the other end in the spill tray.

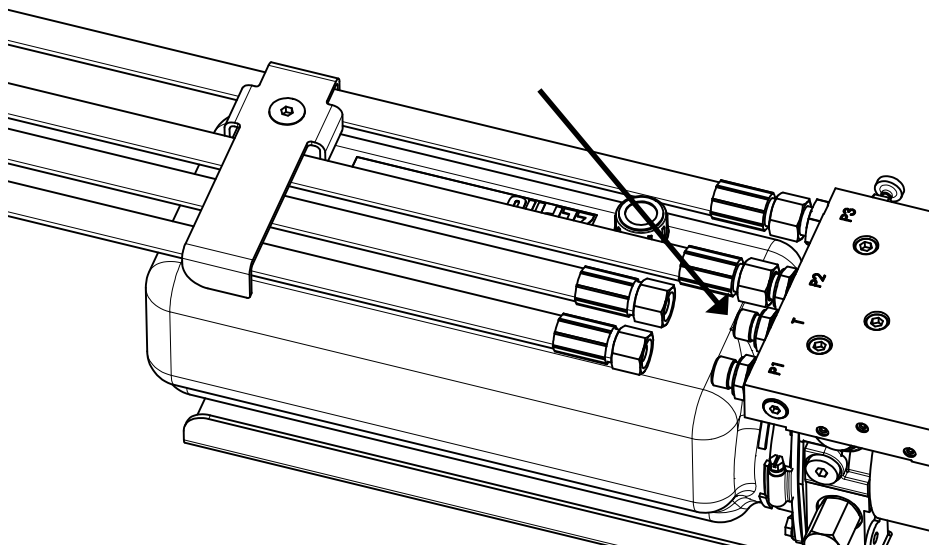

- Lower the lift to the ground in order to empty the lift cylinders as much as possible from oil.
- Suck all oil from the tank.
- When the tank is empty: remove it and clean the strainer, if necessary replace the strainer. Instruction see pages 5-6

Before refilling with new hydraulic oil:
Reconnect all hoses.
Connect the cable to the solenoid again.

Filling (7.5 to 8 liters)

There are two models of tanks with different scale for oil level. Follow the instructions below depending on which tank you have.

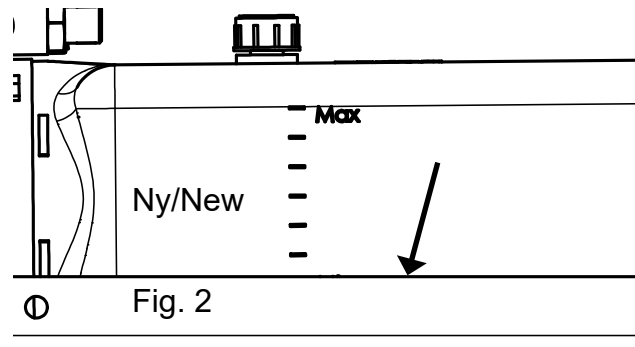
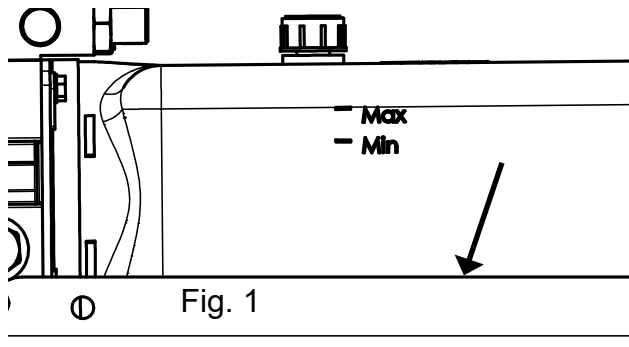

- Fill up the tank with oil to the specified maximum. (Applies to both the tank models)
- Lift and tilt up against the body work, check that the oil level does not fall under the mounting plate edge to prevent the pump from sucking air, see arrows, add more oil over time if needed.
- Tilt out and lower the platform to ground level to fill the cylinders rod side.
- Tank Fig. 1: Refill oil so that the level falls between the maximum and minimum mark on the tank.
- Tank Fig. 2: Refill oil so that the level falls between the maximum and the first level mark below the max mark.
- Repeat this step a few times to get all the air pockets out of the system.

Note! If you have a tail lift that is mounted low so that the lift cylinders are not pressed together completely when lowering to the ground, it is better to refill and check the oil level when the lift is in the transport position, that is, when the platform is closed to the bodywork. The oil must then be level with the mounting plate edge, see arrows (Applies to both the tank models). Repeat the procedure even in this case a few times to get all the air pockets out of the system.

Disassembly hydraulic unit for replacement strainer in connection with oil change. Z/ZL/ZS/ZHD/ZHDL/ZHDN.

If the strainer and / or tank must be cleaned or replaced.

Unscrew the hose holder.

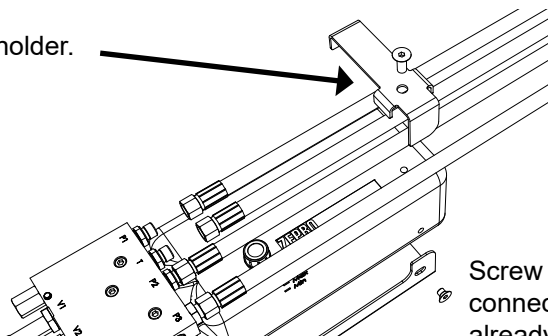

Screw the hoses back on P1 and T connections on the valve block. If it is not already.

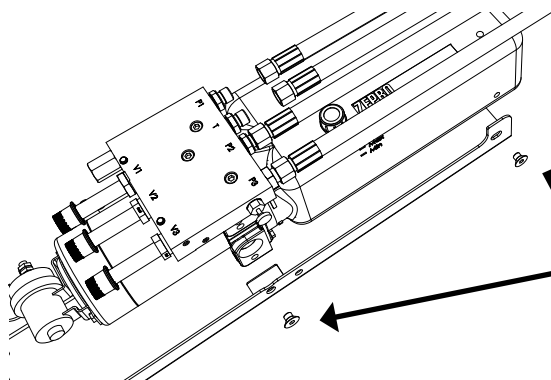
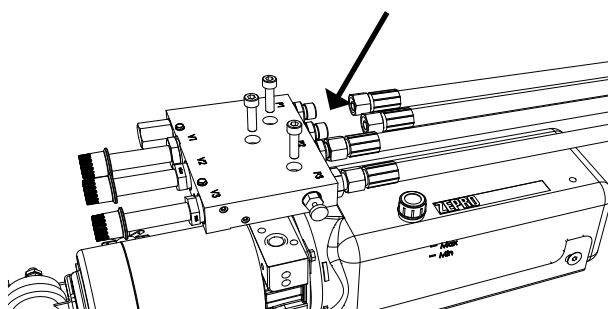

Unscrew the hydraulic unit from the mounting plate, 2 screws.

Loosen the hose clamp that sits at the tank neck. (1)

Unscrew the four screws that secure the tank against the adapter block. (2)

Remove the tank and replace the strainer (3) -See instructions on next page- and o-ring (4) between the adapter block and tank

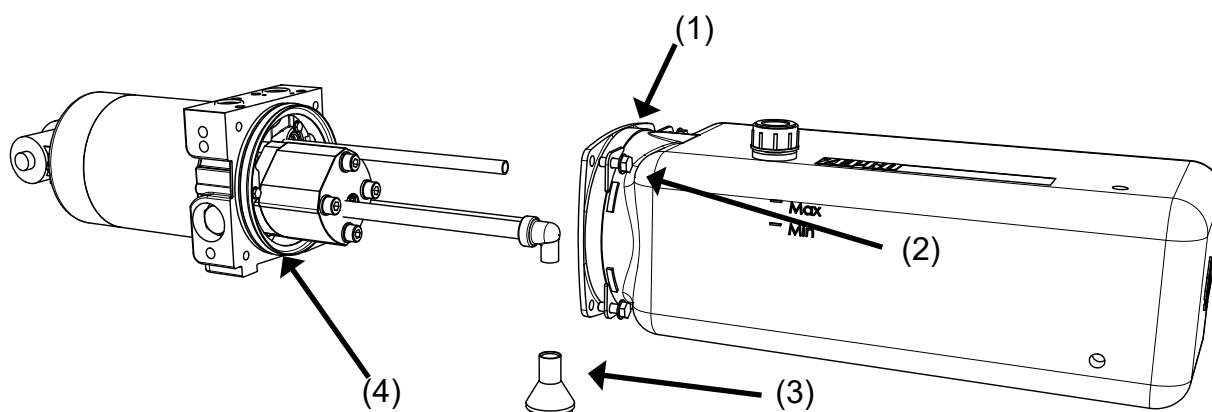

Remount in reverse order.

Clean / replace strainer.

Remove the strainer as shown below.

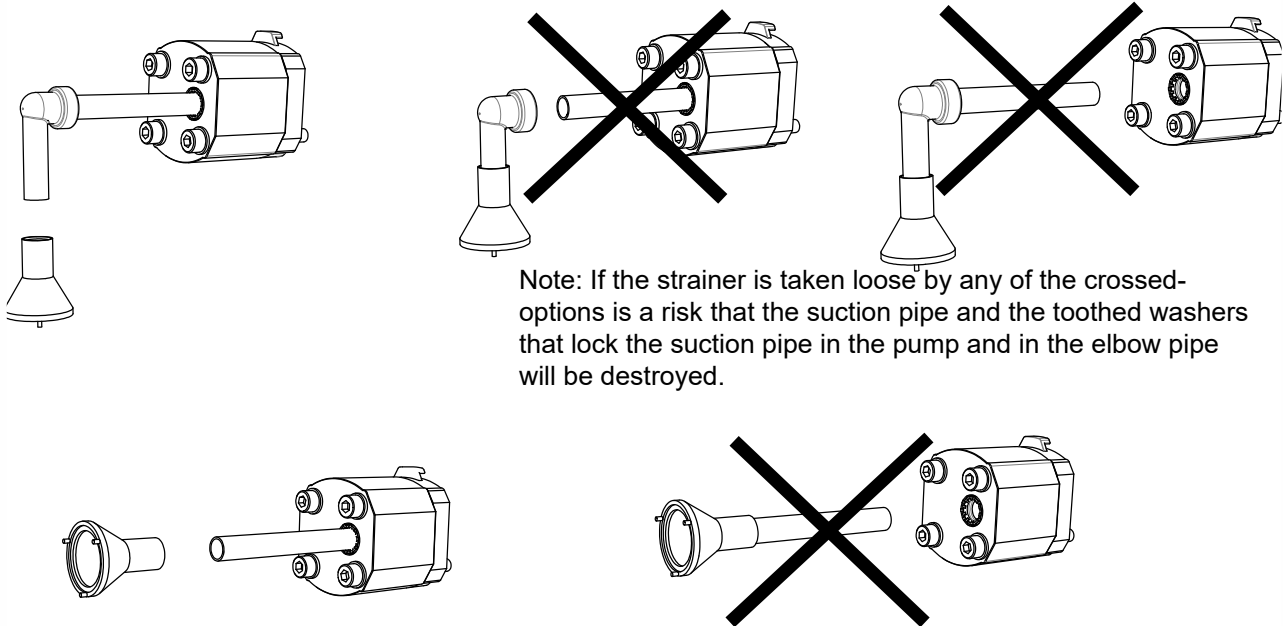

Clean the strainer, preferably with compressed air. Is the strainer too worn or damaged should it be replaced.

Some Z 10/15/20 -130/150 models has a strainer that should be loosen by unscrewing. See picture below.

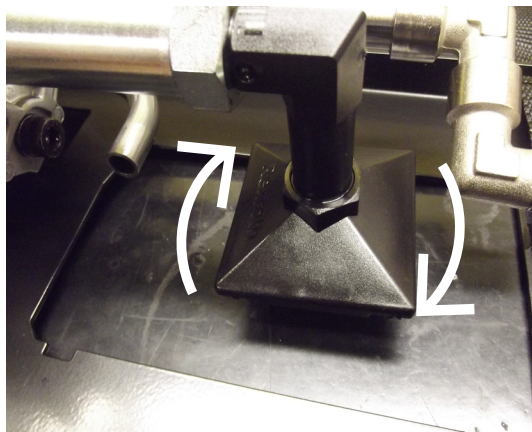

Change of oil at Z 45/75 models

Preparation

- See to have a tray or a can for waste oil at hand.
- Ensure yourself that lift is entirely raised up and closed against body.

Emptying

For safety: Make sure that no one stands behind the tail lift during following operations.

- Loose hose from the hydraulic unit connected to T on the connection block (see figure below) and put it in a tray.
- Use control unit to tilt down the platform in horizontal mode, lower lift as far as possible, thereafter tilt down the platform as much as possible, all this for emptying cylinders as much as possible. If the tank becomes full during the operation: stop and empty the tank, then continue the operation.
- Suck all oil from tank.
- When tank is empty, remove and replace with the new strainer. Applies to XL service, with Servicekit.

Refilling (3.5 to 4 liters)

- Reconnect hose to T.
- Refill tank with oil to maximum.
- Lift up and tilt against body, only fill up if tank is empty.
- There after tilt down and lower to ground to fill up cylinders non-pressure side.
- After pour oil to level between min and max.
- Repeat a couple of times in order to empty system from air.

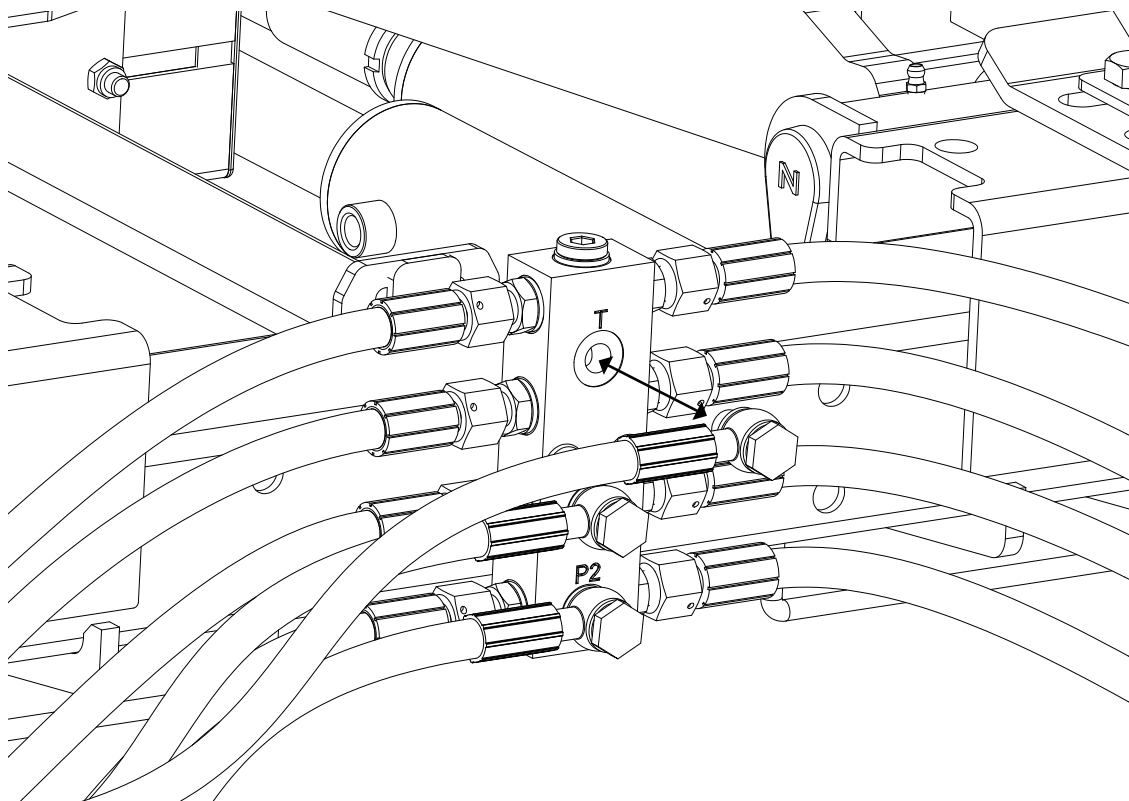

Change of oil at Z 10/15/20 models

Preparation

See to have a tray or a can for waste oil at hand.

Emptying

For safety: Make sure that no one stands behind the tail lift during following operations, or try to operate lift with some of the control units except for the first step below!

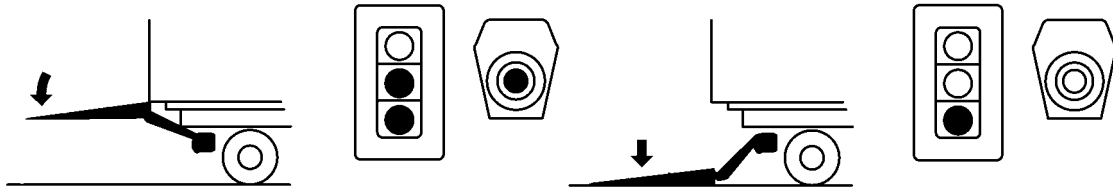

Use control unit to tilt down and lower lift as far as possible, all this for emptying cylinders as much as possible.

Suck all oil from tank.

When the tank is empty: Loosen the two straps.

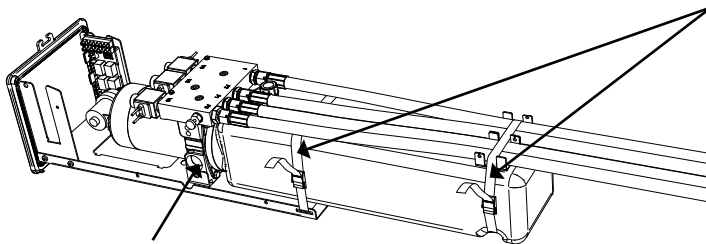

Ease off the motor brace and unscrew the four screws that secure the tank against the adapter block. Remove and clean the tank. Note Some models have only motor brace.

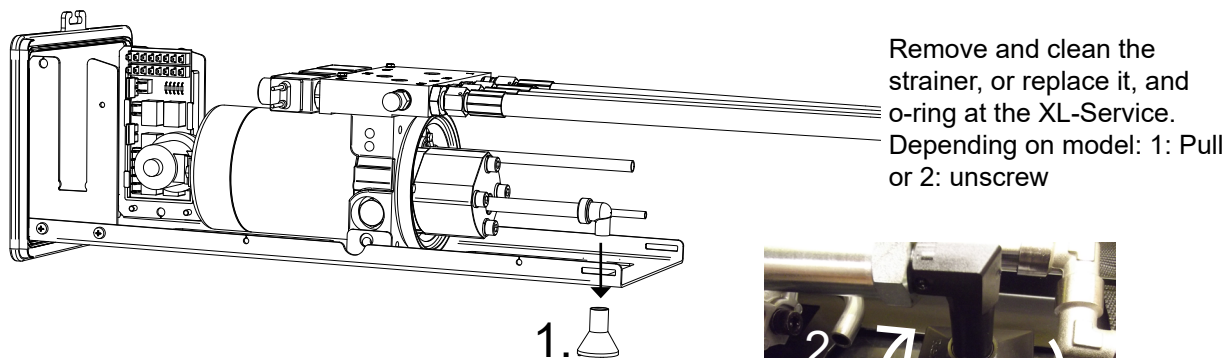

Reassemble in reverse order.

Refill

- Fill up the tank of oil to the specified maximum, either marks on the tank or on the dipstick on the filler cap.
- Lift and tilt up to the body work, if the tank then goes blank, add oil.
- Raise / lower resp. tilting up and down the lift a few times to get as much air pockets as possible from the system.
- Top up oil at a level that falls between the minimum and maximum instructions on the tank level or on the dipstick on the filler cap, depending on the model.

Change of oil at Z 10-135

Preparation

See to have a tray or a can for waste oil at hand.

Emptying

For safety: Make sure that no one stands behind the tail lift during following operations, or try to operate lift with some of the control units except for the first step below!

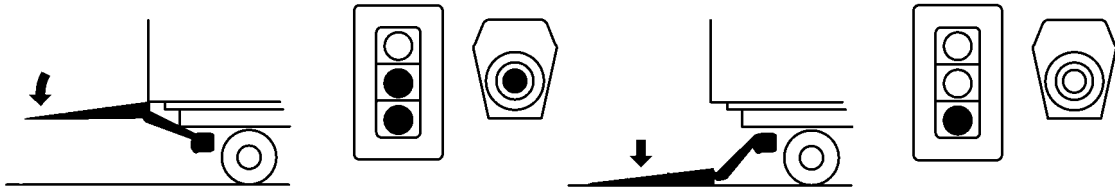

Use control unit to tilt down and lower lift as far as possible, all this for emptying cylinders as much as possible.

Suck all oil from tank.

Ease off the motor brace and unscrew the four screws that secure the tank against the adapter block.
Remove and clean the tank.

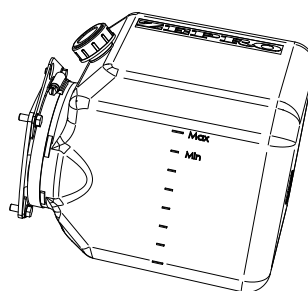
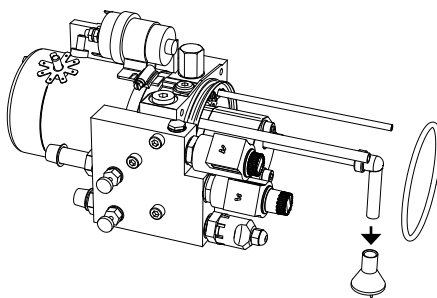
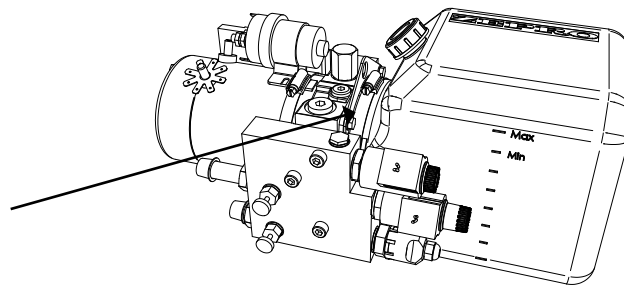

Remove and clean the strainer, or replace it, and o-ring at the XL-Service

Reassemble in reverse order.

Refill

- Fill up the tank of oil to the specified maximum, either marks on the tank or on the dipstick on the filler cap.
- Lift and tilt up to the body work, if the tank then goes blank, add oil.
- Raise / lower resp. tilting up and down the lift a few times to get as much air pockets as possible from the system.
- Top up oil at a level that falls between the minimum and maximum instructions on the tank level or on the dipstick on the filler cap, depending on the model.

Change of oil at ZA/ZAE/ZAHD/ZAEHD models

Förberedelse

- See to have a tray or a can for waste oil at hand.
- Ensure yourself that lift is entirely raised up and closed against body.
- Disconnect the power to lift, preferably at the fuse box.
- Remove magnets from cylinders safety valves (V4 and V5) see fig 1, and unscrew the top of the valves, see fig 2.

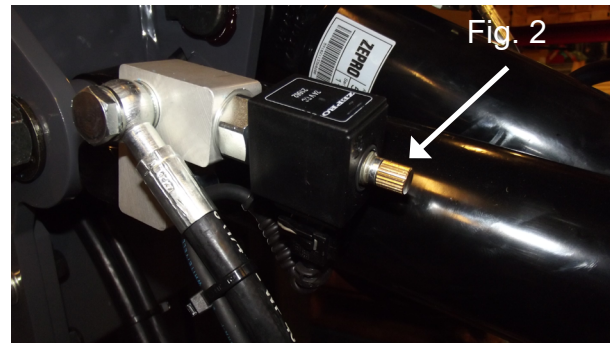
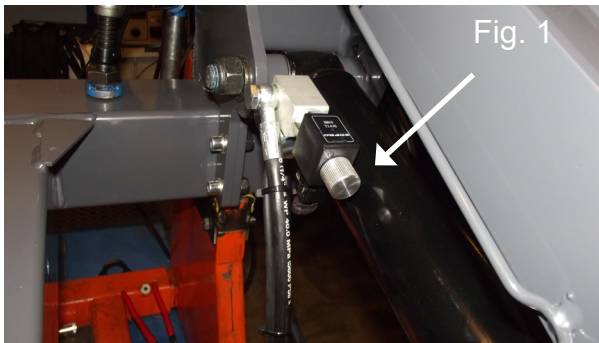

For safety: Make sure that no one stands behind the tail lift during following operations, neither try to operate the lift with some of the control units! It is highly dangerous!

- Start by emptying the tank on the existing oil.
- Loosen the hose connected to P1 (see fig. below) and put it in a spill tray, make sure the hose is not located under eventual surface of oil. Plug connection to P1 or connect an independent hose and place the other end in the spill tray.

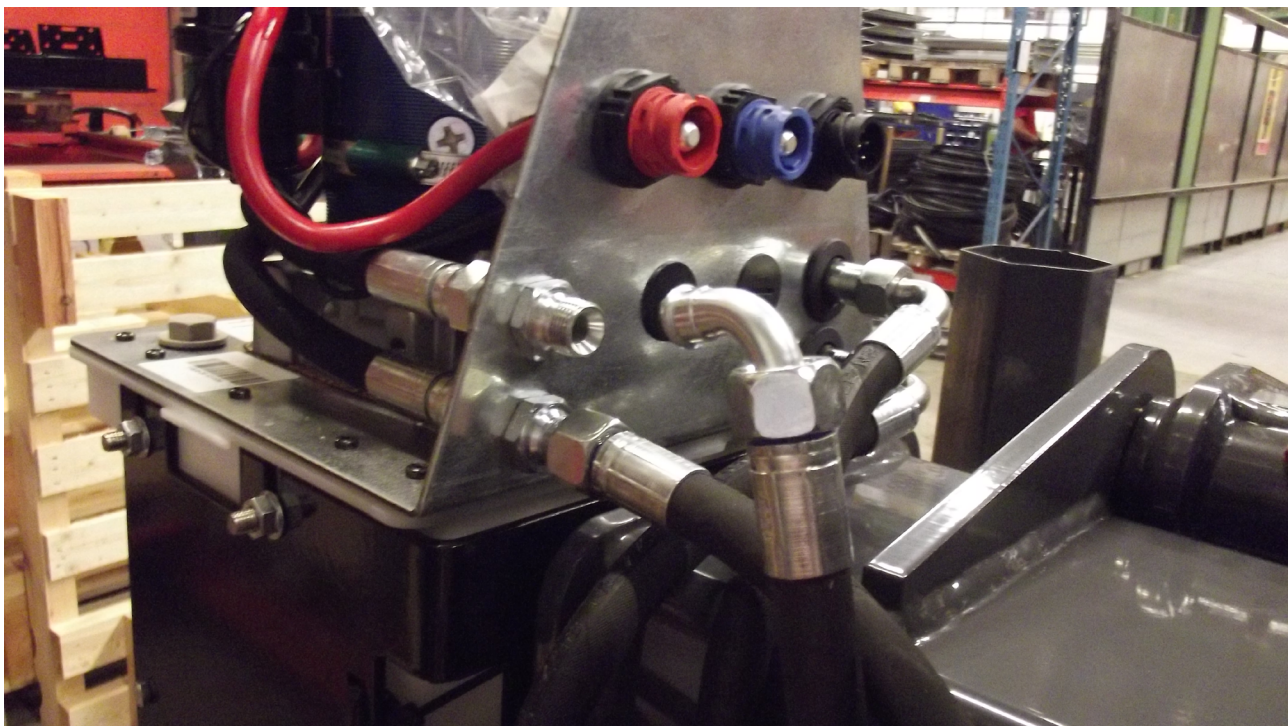

Emptying the tilt cylinders

For Haldex valves (black magnets).

- Unscrew the cap on V1, remove the magnet, screw the cap back
- Unscrew the cap on the V3, remove the magnet, screw back the cap and lift is tilted down. To stop tilting unscrew the cap on the V3.

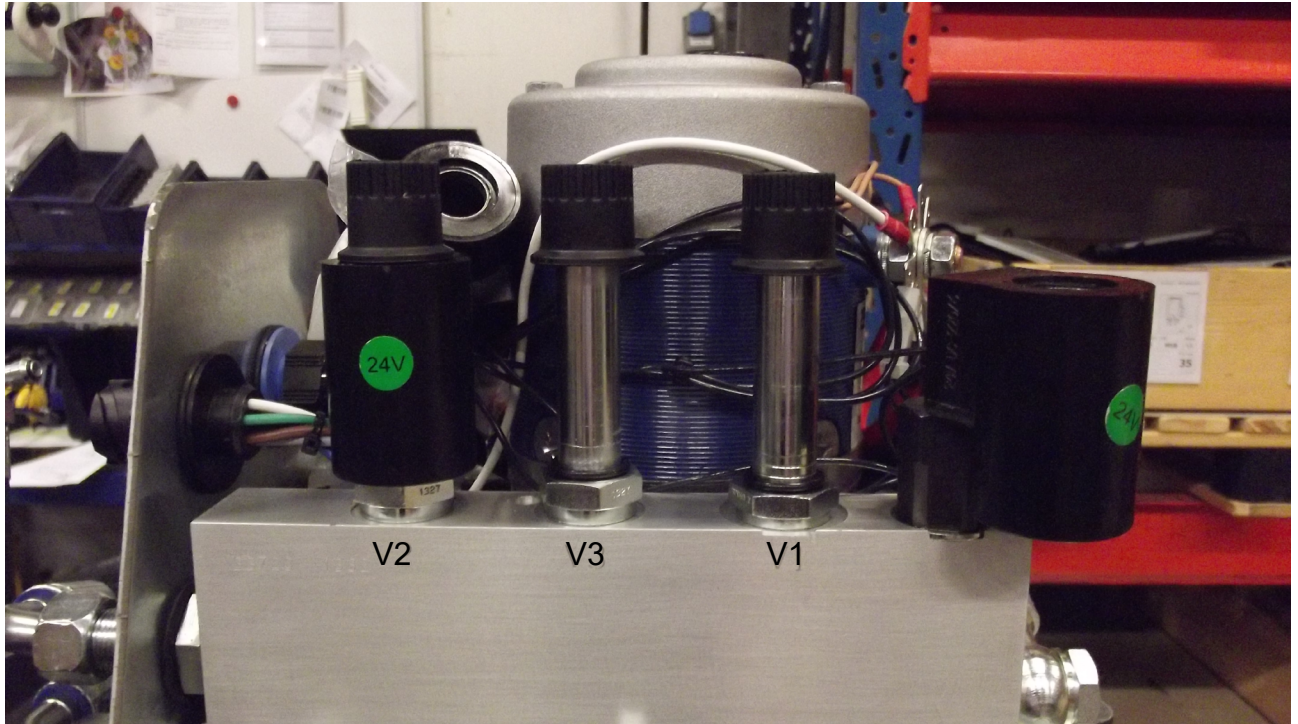

- If the lift is not moving try with skewer or pry bar to help the platform tilt down.
- Soak all the oil from the tank.

Emptying the lift cylinders

- Loosen the hose connected to T (see fig. below) and place in a spill tray, make sure the hose connection is not present below the surface of oil. Plug connection T on the valve system or connect an independent hose and place the other end in the spill tray.

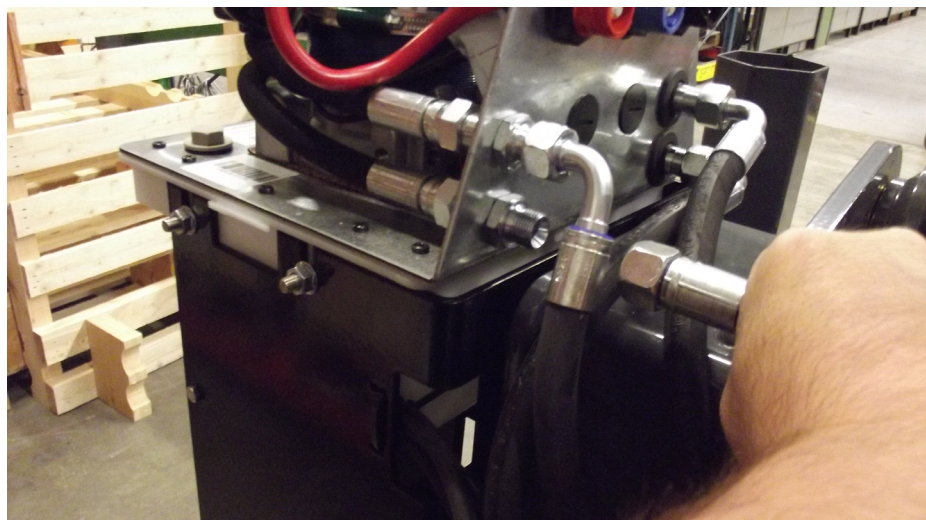

For Haldex valves (black magnets).

- **Unscrew the cap on V1, remove the magnet, screw back the cap.**
- **Unscrew the cap on V2, remove the magnet, screw back the cap and the lift is lowered. To stop lowering, unscrew the cap on V2.**

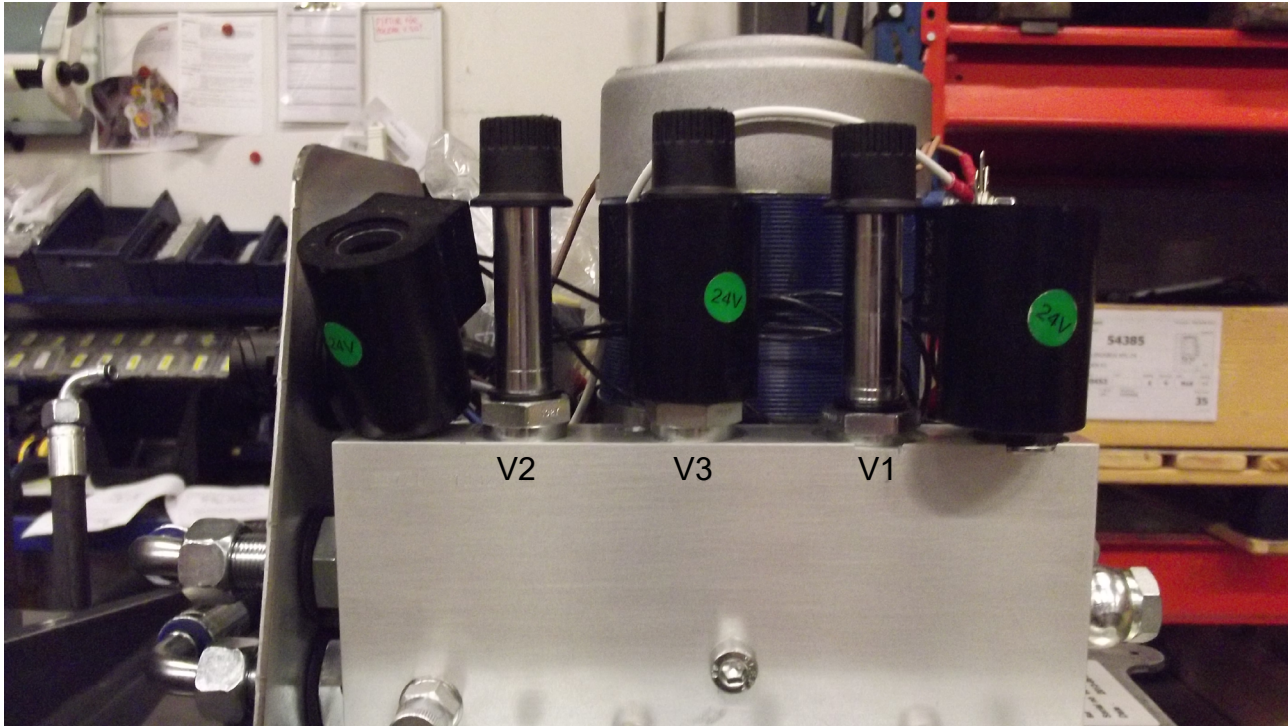

- Soak all the oil from the tank.
- Reset all valves that are manually affected.
- Reconnect all hoses.
- When the tank is empty, remove the strainer and clean if necessary. replace it. Instruction: see next page.

Note: If the lift is not handle as described, and lowered and tilted down before, and oil just sucked out with suction, so will the oil remains in the minus side of the the cylinders.

Refilling

- Fill up the tank with oil to the specified maximum.
- Lift and tilt up to max, if the tank then goes empty, add oil.
- Tilt out and lower the platform to ground level to fill the cylinder piston rod side.
- After Fill oil to the level falls between max and min instructions on the tank.
- Repeat this step a few times to get all the air pockets out from the system.

Disassembly hydraulic unit for replacement strainer in connection with oil change. ZA/ZAE/ZAHD/ZAHD.

If the strainer and / or tank must be cleaned or replaced.

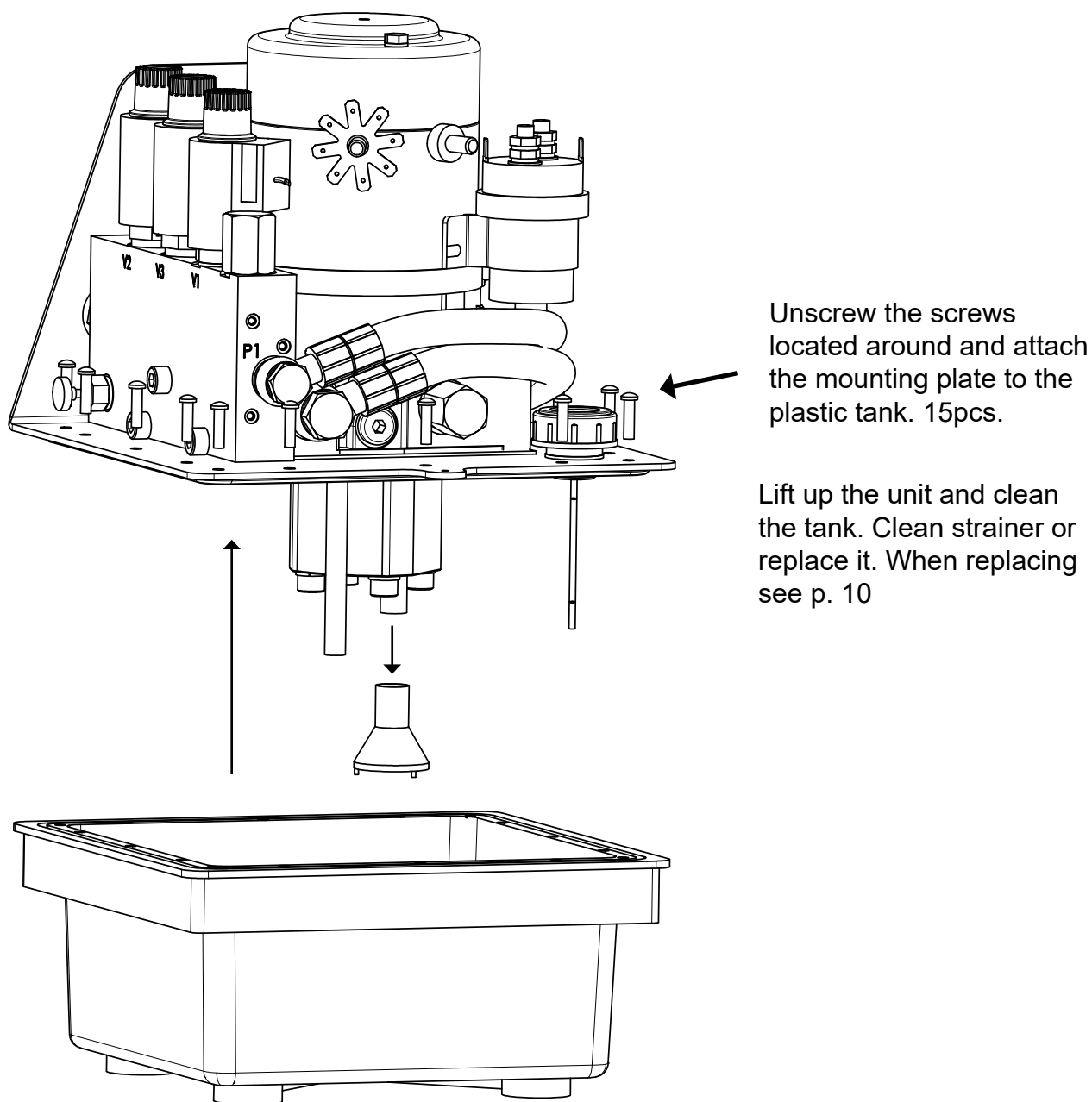

Check that the gasket on the plastic tank is functional, replace if necessary.
Then mount everything back in reverse order.

Note The screws that attach the plate to the plastic tank has a torque of only 1-2 Nm.

Change of oil at ZD/ZS/ZT 15/20/25 models

Preparation

See to have a tray or a can for waste oil at hand.

Emptying

For safety: Make sure that no one stands behind the tail lift during following operations, or try to operate lift with some of the control units except for the first step below!

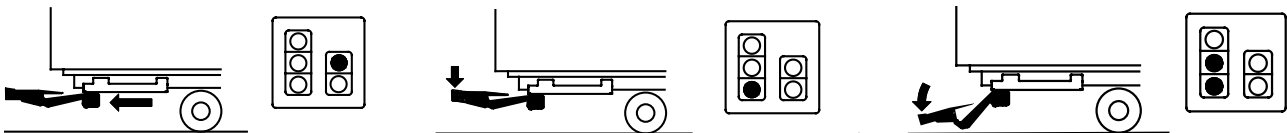

Use control unit to operate the lift into working position. Tilt down and lower lift as far as possible, all this for emptying cylinders as much as possible.

Suck all oil from tank.

When the tank is empty: Loosen the two straps.

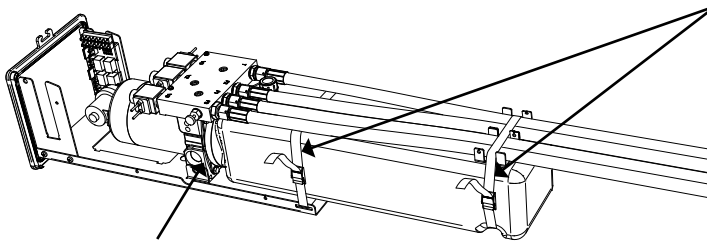

Ease off the motor brace and unscrew the four screws that secure the tank against the adapter block. Remove and clean the tank. Note Some models have only motor brace.

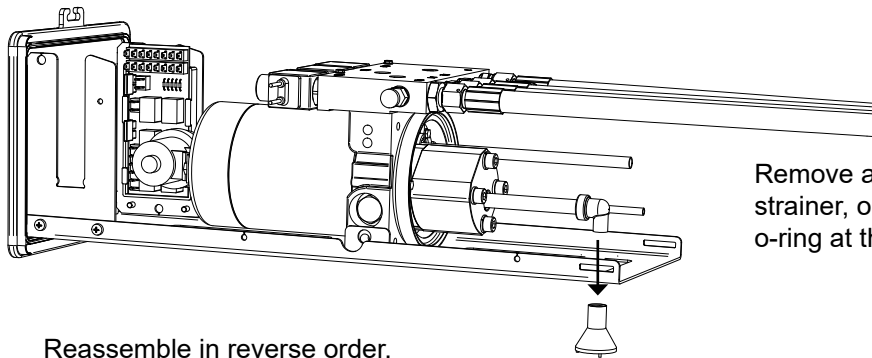

Remove and clean the strainer, or replace it, and o-ring at the XL-Service

Reassemble in reverse order.

Warning!! Never have the platform unfolded when you tilt it up. The platform can slam like a mousetrap that could cause material damage or personal injury. Even make sure that the platform tip doesn't conflict with body work or similar.

Refill

- Fill up the tank of oil to the specified maximum, either marks on the tank or on the dipstick on the filler cap.
- Lift and tilt up as much as possible. **Note see warning above!** If the tank then goes blank, add oil.
- Raise / lower resp. tilting up and down the lift a few times to get as much air pockets as possible from the system.
- Top up oil at a level that falls between the minimum and maximum instructions on the tank level or on the dipstick on the filler cap, depending on the model.

Change of oil at ZHZ 600 models

Preparation

In order to access an oil change, there must be a pit, vehicle lifting or otherwise hoist and secure the rear of the vehicle, so that you can access and lower the hydraulic unit. Have a tray or can for waste oil at hand.

Emptying

For safety: Make sure that no one stands behind the tail lift during following operations.

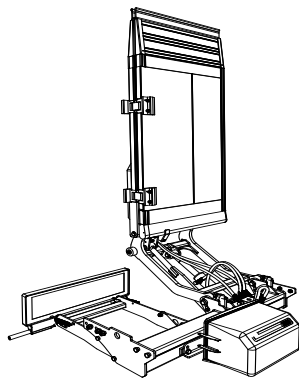

Make sure to have the tail lift in the transport position, see picture to the left.

Loosen the bolts to the bracket for the hydraulic unit, see picture and arrows below. Remove the bolt at arrow 1, let the bolt at arrow 2 remain to get the hinge effect: see picture to the right. Remove the plastic cover from the hydraulic unit.

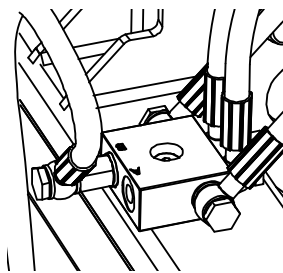
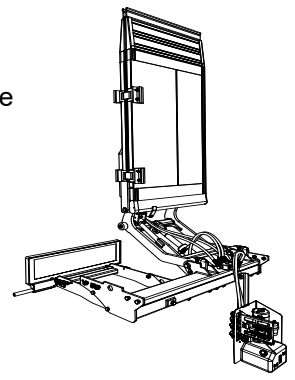
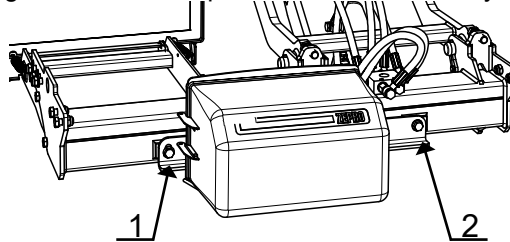

Disconnect the hose from the connector block at port A. See picture to the left. Place the hose in a tray or can for waste oil. See below. Also disconnect the brown cable from the solenoid. see arrow 3 This is so that the motor will not start, the oil collects in the tank and there no risk the pump will suck air and go dry. Use the control unit to lower and tilt down the platform that goes, to empty cylinders with as much oil as possible. Note! It may require manual effort to help tilt the platform from start.

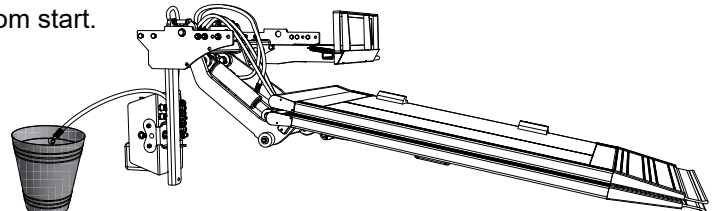
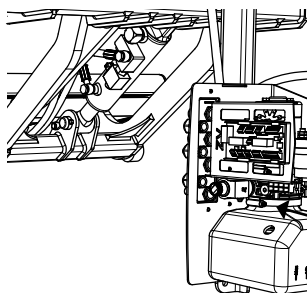

Suck the remaining oil out of the tank. Then remove the tank by loosening the motor brace at the neck of the tank. See arrow 4 in the picture to the left.

Check the strainer: Clean or replace strainer if necessary. Remove the strainer as shown at right. Let the last part towards the pump remain if only cleaning is required.

Reassemble in reverse order, but let the unit "hang" for better access to the filling hole of the tank. Use new rubber steel washers to the hose. After the refilling is done, mount the unit back into place.

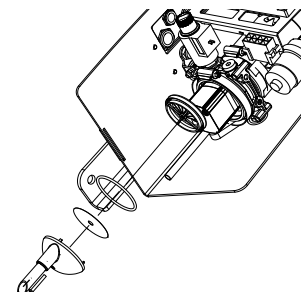

Refill

- Fill up the tank of oil to the specified maximum.
- Run up the tail lift in the transport position. If necessary, add oil so that the pump does not suck air.
- Raise / lower resp. tilting up and down the lift a few times to get as much air pockets as possible from the system.
- Top up oil at a level that falls between the minimum and maximum instructions on the tank.

Change of oil on ZKZ 1500

Preparation

See to have a tray or a can for waste oil at hand.

The locking bar can be in bumper bar position mode during the entire oil change.

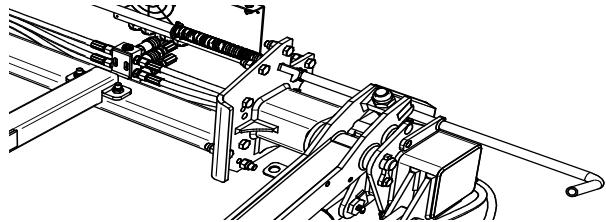

Start by lower the lift in order to unfold the platform. Unfold the platform only once. See picture.

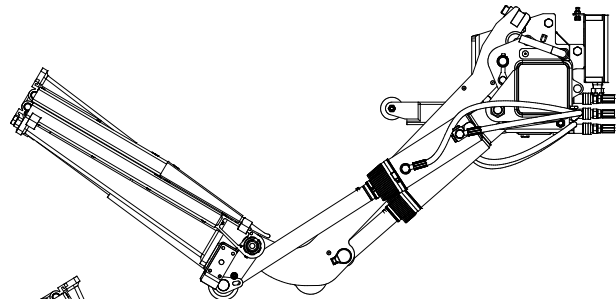

Then run up the lift so it stops against the the lock bar and tilt up the platform to end position.

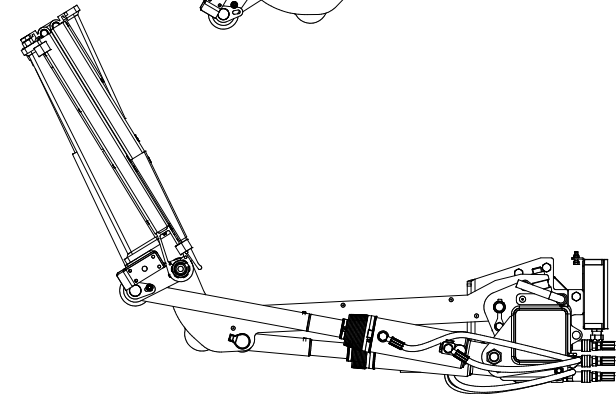

Then break the power to the tail lift, tentatively at the fuse box. The tail lift will then be operate manually to extract as much oil as possible, follow the instructions on the following pages.

For safety: Make sure that no one stands behind the tail lift during following operations, neither try to operate the lift with some of the control units! It is highly dangerous!

- Start by emptying the tank on the existing oil.
- Loosen the hose connected to P1 (see fig. below) and put it in a spill tray, make sure the hose is not located under eventual surface of oil. Plug connection to P1 or connect an independent hose and place the other end in the spill tray, in order to reduce oil spill.

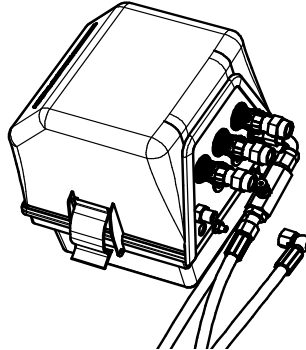

- Remove magnets from the safety valves of the cylinders (V4 and V5) see fig 1, and unscrew the top of the valves, see fig 2.

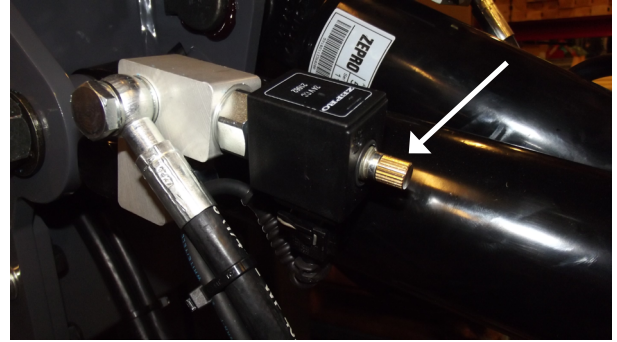
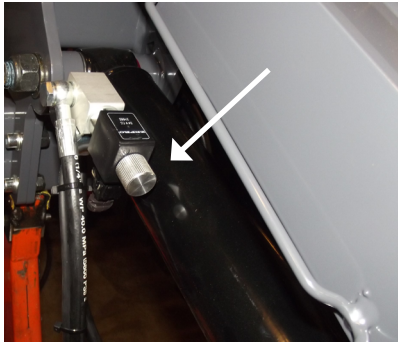

Emptying the tilt cylinders

For Haldex valves (black magnets).

- Unscrew the cap on V1, remove the magnet, screw the cap back
- Unscrew the cap on the V3, remove the magnet, screw back the cap and lift is tilted down. To stop tilting unscrew the cap on the V3.

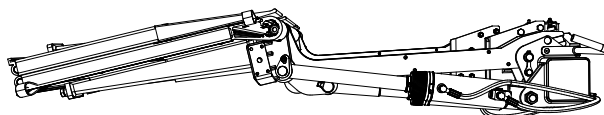
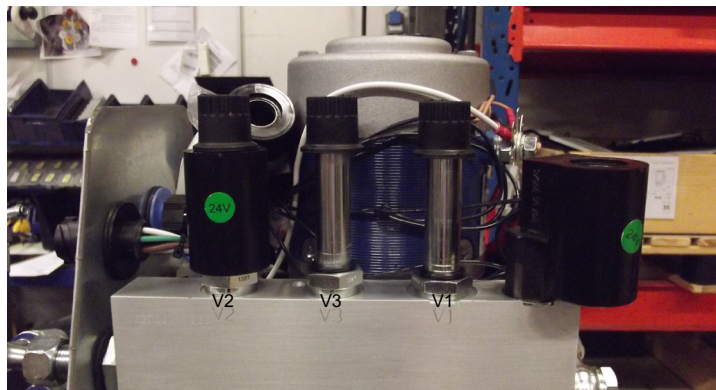

Emptying the lift cylinders

For Haldex valves (black magnets).

- Unscrew the cap on V1, remove the magnet, screw back the cap.
- Unscrew the cap on V2, remove the magnet, screw back the cap and the lift is lowered. To stop lowering, unscrew the cap on V2.

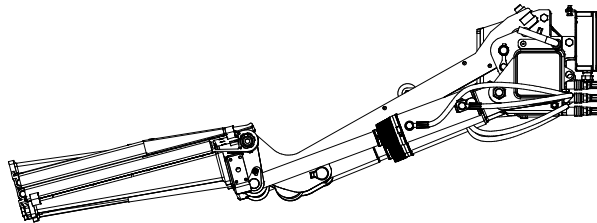
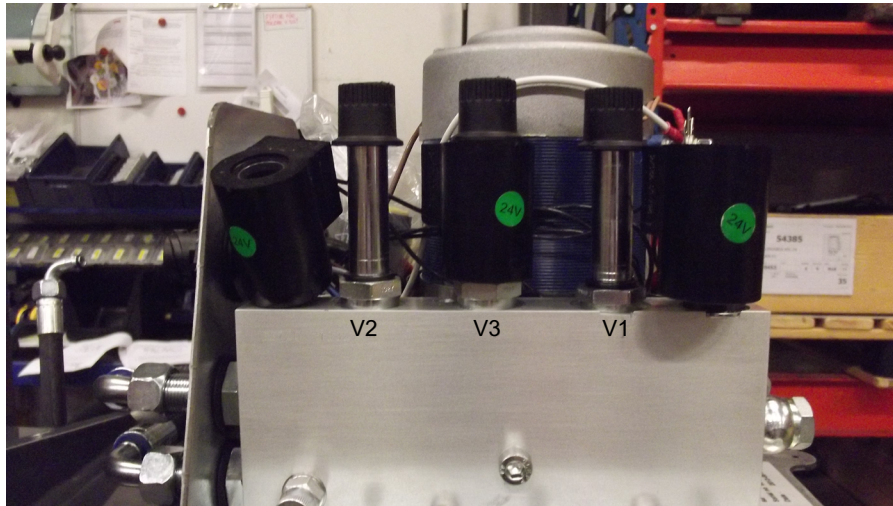

- Soak all the oil from the tank.
- Reset all valves that are manually affected.
- Reconnect the hose.
- When the tank is empty, remove the strainer and clean if necessary. replace it. For instruction: see page 17.

Note: If the lift is not handle as described, and lowered and tilted down before, and oil just sucked out with suction, will the oil remains in the minus side of the the cylinders.

Refilling

- Connect the power to the tail lift again
- Fill up the tank with oil to the specified maximum.
- Lift and tilt up to max, if the oil level goes under the suction strainer, add more oil.
- Tilt up and down some times to fill the cylinder piston rod side and get air out of the system.
- Lower the lift to the ground and tilt down all that is possible.
- If neccissary: After fill oil to the level falls between max and min instructions on the oilstick on the cap.

Change of oil on Z3N/Z3NU 75

Preparation

Make sure to have the tail lift in transport position, see picture.
Have a tray or can for waste oil at hand..

Start by empty the tank on existing oil. (1)

Then loosen the hose coming from the hydraulic unit and is connected to the center adapter on the connector block on the support frame for further branching to the minus side of the tilt cylinders (see Pic. A).

Place the end of the hose into a collecting vessel.

On the newer model of connection block, it is the lower hose that must be loosened. (See Pic. B)

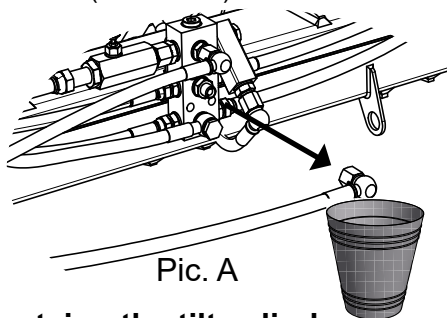

Pic. A

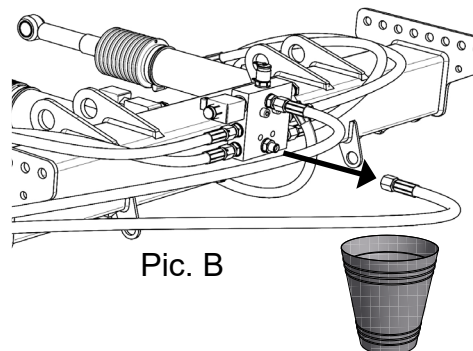

Pic. B

Emptying the tilt cylinders

Disconnect the brown wire from the solenoid (2) so the safety valves can be affected without the motor starts. Open the valves by operate the tail lift as usually with the control unit. Tilt down until the end position for emptying cylinders as much as possible. It may be necessary to manual help the platform to start tilt from the transport position.

Note! Make sure that the tank will not be overfilled during the operation.

Suction tank when necessary.

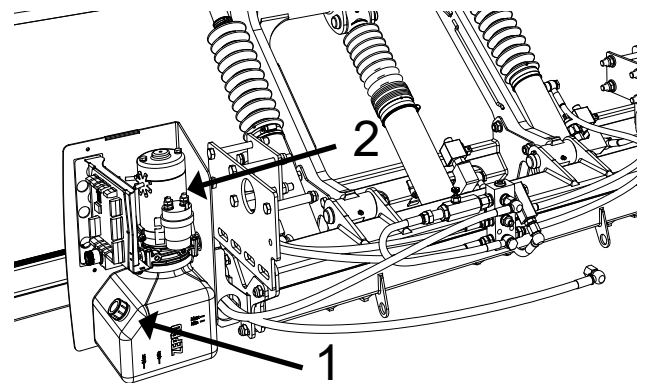

Emptying the lift cylinder

Continue to lower the platform to the ground to empty the lift cylinder, still with the motor still disconnected. Also check now that the tank will not overflow.

Suction remaining oil out from the tank. The system is now so empty it can be. Remove and clean the tank and check the strainer.

If necessary, replace the strainer. (See instruction 73625TL Replacing the pump and / or suction strainer).

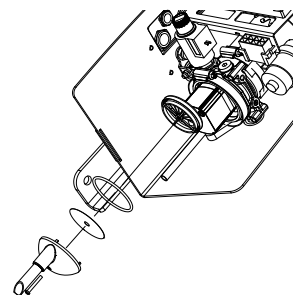

Reassemble everything in place before refilling oil.

Refill

- Fill up the tank of oil to the specified maximum.
- Operate the tail lift in the transport position. If necessary, add oil so that the pump does not suck air.
- Raise / lower resp. tilting up and down the lift a few times to get as much air pockets as possible from the system.
- Top up oil at a level that falls between the minimum and maximum instructions on the tank. This operation should be done when the platform is lowered and tilted down as much as possible.

Change of oil on SZFT/SZFTN/SZFTS 200-160

Preparation

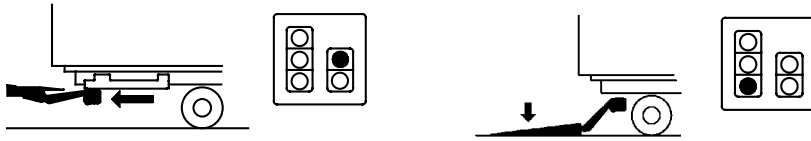

Operate the lift into working position. Lower it to the ground, this to empty the cylinders as much as possible of oil.

Emptying:

For safety: Make sure that no one stands behind the tail lift during following operations, or try to operate the lift with some of the control units!

Remove the cover on the hydraulic unit and the cap on the tank. Suck the tank empty from oil..

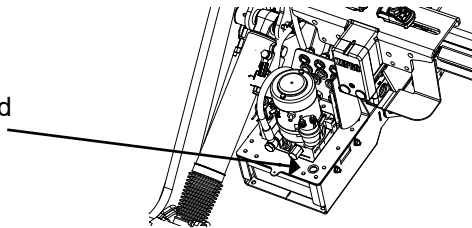

If the strainer needs to be cleaned or replaced:

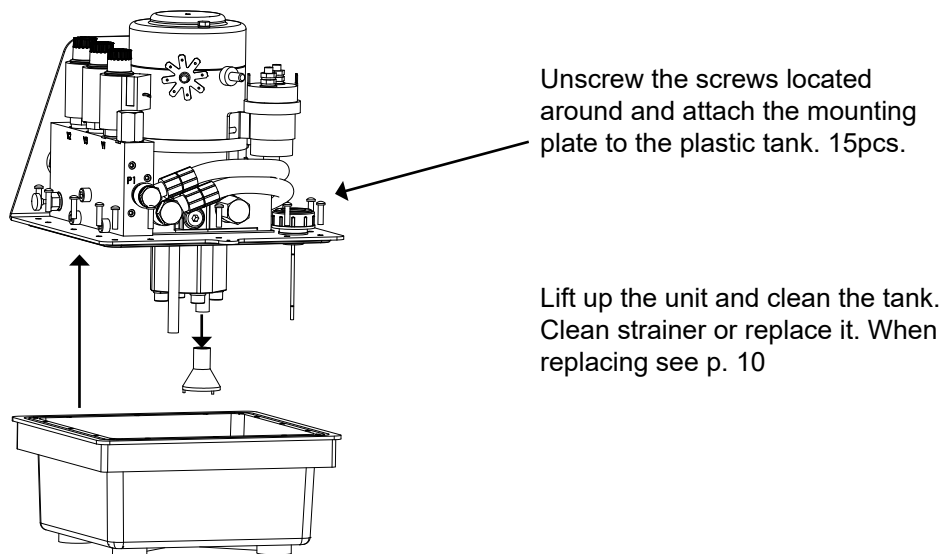

Check that the gasket on the plastic tank is functional, replace if necessary. Then mount everything back in reverse order.

Note The screws that attach the plate to the plastic tank has a torque of only 1-2 Nm.

Refill:

- Fill up the tank with oil to the maximum specified on the dipstick.
 - Raise the lift to the max to fill the cylinders with oil. Make sure that the oil level in the tank will not becomes too low, so the pump sucks air. Add oil if necessary.
 - Lower and raise the lift to the max, repeat this step a few times to get all the air pockets out of the system.
 - Refill oil so that the level falls between the maximum and minimum on the dipstick.
 - Note: The level should be checked when the lift is lowered to the ground.
- Oil volume: 3-4 liters

Change of oil on på ZR 10/15-135

Preparation

Lower the lift as much as possible in order to empty the cylinders maximum of oil.

NB!! DO NOT STAND BEHIND THE LIFT DURING LOWERING.
The platform can fall out by itself if its not properly adjusted.

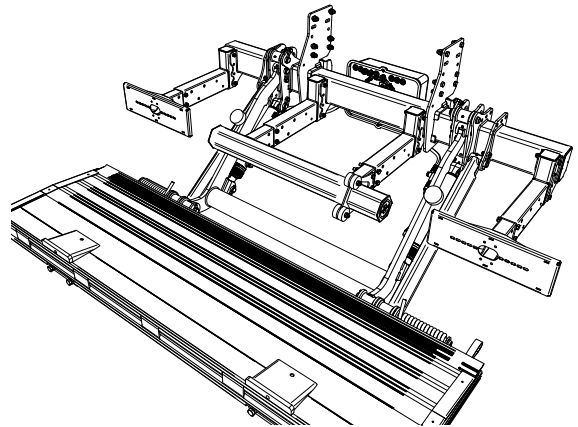

Emptying:

For safety: Make sure that no one stands behind the tail lift during following operations, or try to operate the lift with some of the control units!

Remove the cover on the hydraulic unit and the cap on the tank. Suck the tank empty from oil..

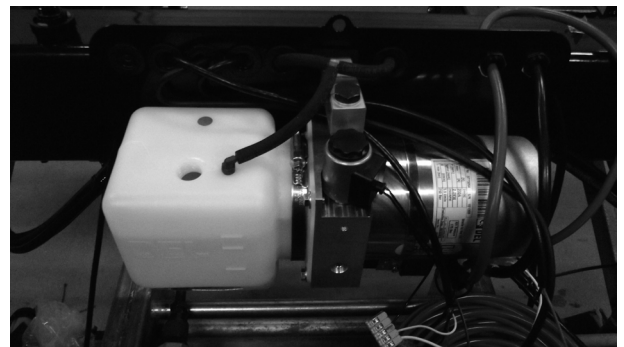

If the strainer needs to be cleaned or replaced:

Ease off the motor brace and unscrew the four screws that secure the tank against the adapter block. Remove and clean the tank.



Pull the strainer downwards and clean it. Replace if necessary. Reassemble in reverse order.

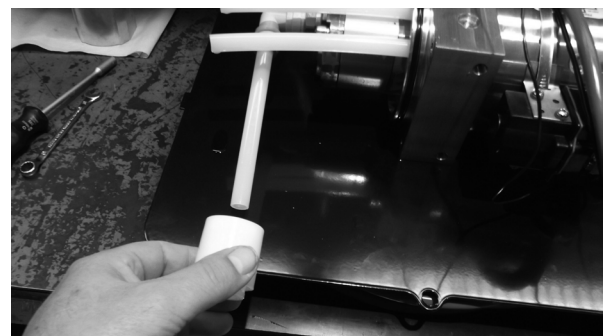

Refill:

- Fill up the tank with oil, (2,3 liter)
- Make a test run of the lift.
Fasten the cover on the hudraulic unit.

Change of oil at ZR 15/20 - 140/157

Preparation

Lower the lift to the ground, this to empty the cylinders as much as possible of oil.

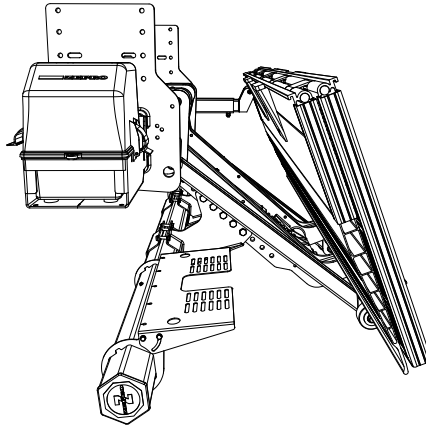

Emptying:

For safety: Make sure that no one stands behind the tail lift during following operations, or try to operate the lift with some of the control units!

Remove the cover on the hydraulic unit and the cap on the tank. Suck the tank empty from oil..

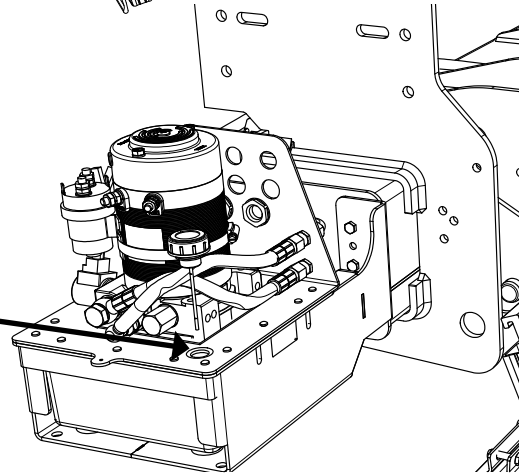

If the strainer needs to be cleaned or replaced:

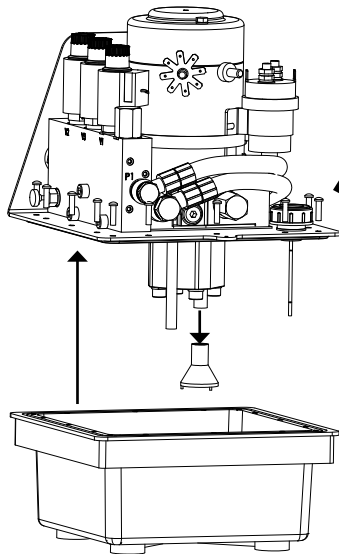

Unscrew the screws located around and attach the mounting plate to the plastic tank. 15pcs.

Lift up the unit and clean the tank. Clean strainer or replace it. When replacing see p. 10

Check that the gasket on the plastic tank is functional, replace if necessary. Then mount everything back in reverse order.

Note The screws that attach the plate to the plastic tank has a torque of only 1-2 Nm.

Refill:

- Fill up the tank with oil to the maximum specified on the dipstick.
 - Raise the lift to the max to fill the cylinders with oil. Make sure that the oil level in the tank will not becomes too low, so the pump sucks air. Add oil if necessary.
 - Lower and raise the lift to the max, repeat this step a few times to get all the air pockets out of the system.
 - Refill oil so that the level falls between the maximum and minimum on the dipstick.
 - Note: The level should be checked when the lift is lowered to the ground.
- Oil volume: 3-4 liters

Change of oil at BZ/RZ 20-150 models

Preparation

- See to have a tray or a can for waste oil at hand.
- Ensure yourself that lift is entirely raised up and closed against body.

Emptying

For safety: Make sure that no one stands behind the tail lift during following operations, or try to operate the lift with some of the control units!

- Loose hose for distribution that is connected to tilt cylinders non-pressure side at connection on hydraulic unit. Put in a tray, ensure that hose connection not are located under possible oil surface
- Steer by force valve V3
- Use control unit and push "lower" button on which lift tilts out. Keep the button pushed until the tilt cylinders touch bottom. (If the lift don't move, try iron bar and breaking iron to help lift tilt down.)
- Restore the hand operated valve V3.
- Suck all oil from tank,
- Use control unit and push "lower" button on which lift lowers. Keep the button pushed until lift cylinders has been drained off.
- Suck all oil from tank,
- Reconnect hose.
- When tank is empty, remove and use compressed air to clean filter and strain tube.

Refill

- Refill tank with oil to maximum.
- Lift up and tilt against body, only fill up if tank is empty.
- There after tilt down and lower to ground to fill up cylinders non-pressure side.
- After pour oil to level between min. and max.
- Repeat a couple of times in order to empty system from air.

Change of oil at BZ/RZ 15/20-154 models

Preparation

- See to have a tray or a can for waste oil at hand.
- Ensure yourself that lift is entirely raised up and closed against body.

Emptying

For safety: Make sure that no one stands behind the tail lift during following operations, or try to operate lift with some of the control units!

- Loose brown cable which is connected between circuit card and switch.
- Loose hose for distribution which is connected to cylinders non-pressure side at connection on hydraulic unit. Put in a tray, ensure that hose connection not are located under possible oil surface.
- Steer by force valve V3
- Use control unit and push "lower" button on which lift tilts out. Keep the button pushed until the tilt cylinders touch bottom. (If the lift don't move, try iron bar and breaking iron to help lift tilt down.)
- Restore the hand operated valve V3.
- Suck all oil from tank. If there is a drain plug, take benefit.
- Use control unit and push "lower" button on which lift lowers. Keep the button pushed until lift cylinders has been drained off.
- Suck all oil from tank. If there is a drain plug, take benefit.
- Reconnect hose and brown cable to switch.
- When tank is empty, remove and use compressed air to clean filter and strain tube.

Refill

- Refill tank with oil to maximum.
- Lift up and tilt against body, only fill up if tank is empty.
- There after tilt down and lower to ground to fill up cylinders non-pressure side.
- After pour oil to level between min. and max.
- Repeat a couple of times in order to empty system from air

Change of oil at BZ/RZ 10/15/20-130/149 models

Preparation

- See to have a tray or a can for waste oil at hand.

Emptying

For safety: Make sure that no one stands behind the tail lift during following operations, or try to operate lift with some of the control units!

- Use control unit to tilt down and lower lift as far as possible, all this for emptying cylinders as much as possible.
- Open drain plug and put a tray below.
- When tank is empty, remove and use compressed air to clean filter and strain tube.

Refill

- Refill tank with oil to maximum.
- Lift up and tilt against body, only fill up if tank is empty.
- Lift / lower respectively tilt up and tilt down lift a couple of times in order to empty system from air.
- After pour oil to level between min. and max.

Installation instructions regarding extra oil filter on the return hose.

The filter fits our lift models with plastic tank. Except on ZR 10/15-135 and some few tail lifts of Z 15/20 until 2013, which has a return tube assembly instead of the blue return hose.

The instruction shows how the filter is mounted and placed on three of our hydraulic units. Should you have a

model that is not included in the pictures in this instruction, please refer to the general information.

Preperation: Lower the platform to the ground and tilt down as much as possible. This to make the hydraulic system pressureless.

Disconnect the power to the lift.

Then empty the tank, at least, so that you can loosen and put back the tank without spoiling oil. See instruction

IE-0102 Change of oil, and follow the instruction for your lift modell untill the tank is removed.

Available at www.zepro.com and in C-Files: www.c-office.com

General information:

General information: Mount the filter on the blue return hose (Ø10mm) so that the filter comes as close to the bottom of the tank as possible. Cut a piece of the return hose if necessary,

Tighten the hose clamp so that the filter fits properly on the return hose.

Then reinstall all and refill oil according to instruction IE-0102 Oil Change:

Available at www.zepro.com and in C-Files: www.c-office.com



Some overview pictures on the next page shows how the filter should be placed inside the tank for som different kind of hydraulic units. On one model it is necessary to cut the blue return hose.

See information on the next page.

Model 1 : E.g Z 45/75 models.



Lenght on the hose 120 mm.



No need to be cut. Just mount the filter on the hose.



How the filter should be placed inside the tank.

Model 2: E.g Z 1500/2000 (Lift models with the hydraulic unit inside the support frame).

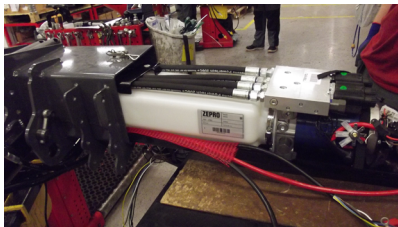

Lenght on the hose 300 mm.



No need to be cut. Just mount the filter on the hose.

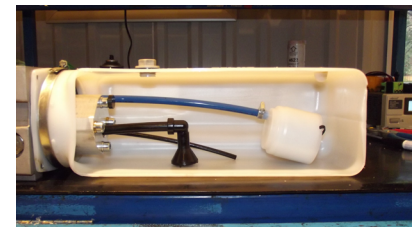

How the filter should be placed inside the tank.

Model 3: E.g ZA, ZR, SZF Models.



On this model the return hose needs to be cut.



Cut the return hose so it's lenght is 60 mm. 50-52 mm should be left after fastening in to the adapter block.



Mont the filter as shown.



How the filter should be placed inside the tank.